

## 50-S-54 - SPEEDLINE System Data Sheet - Version V1 (24-10-23)

SPEEDLINE 50mm 'C' Stud Partition @600mm Ctrs,  
with Siniat GTEC 15mm dB Board each side

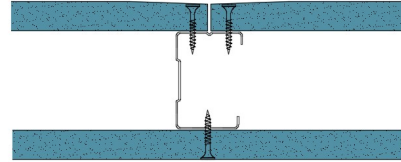

### System Performance Breakdown

Fire Resistance:

BS476 Part 22:1987:

Test Ref & Date or Applied Ref & Report:

Max Height:

Thickness:

Duty Grade: BS 5234: Part 2:1992:

Sound Insulation:

**30/30 Minutes** (Integrity/Insulation).

**BRE 269826 - BRE Report P102396-1011C**

**Refer to Speedline Specification Clause**

**82 mm.** (At Base Track, Excluding Finishes)

**Heavy - Annexes A-F**

**38  $R_w$ dB**, Date Tested or Assessed Against - 27/07/2011

Test Code:  
H17505AA  
Test Date:  
27/07/2011

Freq. Hz	R dB
50	21.6
63	15.4
80	12.6
100	10.7
125	14.4
160	22.5
200	30.2
250	30.4
315	31.7
400	37.6
500	41.9
630	45.4
800	50.3
1 000	52.2
1 250	53.9
1 600	51.2
2 000	40.5
2 500	37.0
3 150	41.4
4 000	45.4
5 000	47.0
6 300	
8 000	
10 000	

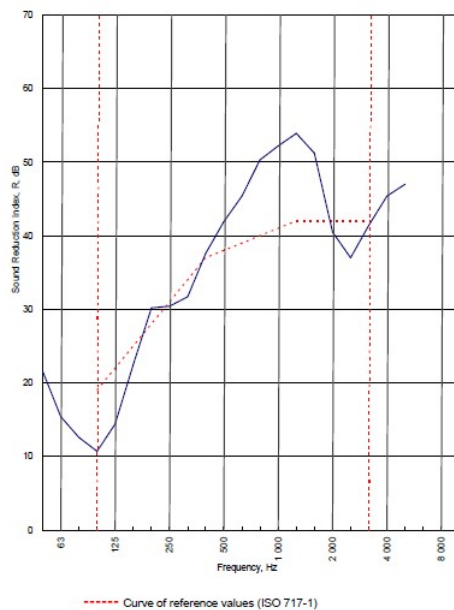

Rating according to BS EN ISO 717-1:1997	<b><math>R_w</math> (C;Ctr) = 38 (-3;-10) dB</b>		
Evaluation based on laboratory measurement results obtained by an engineering method:	$C_{50-3150}$ = -3 dB	$C_{50-5000}$ = -3 dB	$C_{100-5000}$ = -2 dB
	$C_{1,50-3150}$ = -11 dB	$C_{1,50-5000}$ = -11 dB	$C_{1,100-5000}$ = -10 dB

TESTED AT ONE OF THE UKAS  
ACCREDITED LABORATORIES  
BELOW

B.T.C  
(H-Ref on Graph)



B.R.E



AIRO



S.R.L



Customer: Metsec plc Hepsec Division

BTC 17505A: Page 8 of 10

SPEEDLINE Drywall Systems, Adsetts House, 16 Europa View, Sheffield Business Park, Sheffield, S9 1XH.

Tel: 0114 231 8030.

Email: [enquiries@speedlinedrywall.co.uk](mailto:enquiries@speedlinedrywall.co.uk)

(As per the requirements set out in ISO/IEC 17025:2017 regarding test data the results stated have been carried out by voestalpine Metsec plc as part of the contract to supply Speedline Metal Sections to SIG Plc)